



## Wallendbeen Public School

### Attendance Policy

**Aim:** To record and monitor student's attendance in order that regular attendance of students will be encouraged and to enable steps to be taken which will improve poor attendance.

#### Responsibilities

##### **Parents:**

understand the legal requirements and education necessity for regular school attendance,  
are helped to overcome problems that contribute to poor school attendance.  
will provide written notes explaining absences.

##### **Students:**

take pride in regular attendance  
are assisted in overcoming problems that contribute to poor attendance.  
roll Marking Procedure:  
as at January 2018 all teachers will mark the roll daily and accurately using EBS ontrack.

##### **Student Left:**

When a student leaves the school they are marked as Left in EBS ontrack by the office staff.

##### **Strategies for Good Attendance:**

Teachers will provide a caring & stimulating learning environment in which students are able to achieve success and recognition for success every day.  
Class teachers will provide awards for 100% attendance each term.  
School will provide end of year certificates for students with 2 days or less absences.  
Procedures for notification of absence and the importance of prompt arrive will be regularly inserted in the newsletter and regularly reported on at parent meetings, P&C meetings etc

##### **The following points should be noted:**

Late arrivals and early departures should present themselves at the office so office staff may make a note in EBS ontrack.  
Students must not leave early unless collected by a parent/caregiver or their approved nominated persons. If a student consistently arrives late or leaves early the relevant teacher needs to alert the Principal.  
Unexplained or unsatisfactory reason for absences should be marked "A".  
**Note: Exemptions can no longer be requested or approved for parents / caregivers going on holidays during a school term. These absences are marked as leave (L) and are counted in the students attendance record.**

# Wallendbeen Public School Bulletin

#### **Term Dates for 2018**

**Term 1**—30/1/18— 13/4/18  
**Term 2** - 1/5/18 —6/7/18  
**Term 3** - 24/7/17 —28/9/18  
**Term 4** - 15/10/18 — 19/12/18

Friday, 23rd February, 2018



"From Small Beginnings"  
Established 1881

### **PRINCIPALS REPORT**

Dear Parents,

The Baldry Shield is fast approaching and once again we call on our fabulous community spirit to assist us in running another successful carnival. We are looking for volunteers on the day to help in the canteen, on the BBQ, selling raffle tickets and if you are a keen athlete we can even find a job on the field. If you can not make it on the day we are looking for donations of slices, cakes and biscuits to sell.

We are also organising an Easter Raffle for the day and are currently seeking donations of Easter Eggs and any nice baskets we may present the prizes in., would be greatly appreciated.

Another initiative for a fundraising item at the Baldry Shield is to convert our delicious tomatoes grown in our garden into tomatoes relish. We do ask that our tomatoes stay on our vines so we have enough to make the relish. Please keep an eye on our gardens over the week-ends and should you see anyone on the school grounds, either notify me or ask them politely to leave. Now could be a timely reminder that the Department of Education have the enclosed grounds act and if people are on the grounds outside school hours without permission they can be prosecuted.

The students have had a wonderful learning opportunity this week with the baking of cookies whilst learning the names of the ingredients, colours of the smarties and number of cookies in German. Thank you Mrs Clark for your instruction and time.

Last year our student refrigerator failed, a big thank you to Nanny and Rob Anderson who donated their spare fridge. With the warm weather, having somewhere to keep our lunches cold is great.

Have a great fortnight.

Mrs Toni Daly  
Principal

#### **2018 Term 1 diary dates to remember**

**12 Mar — Swimming lessons start (2 weeks)**

**29 Mar —Baldry Shield**

**5th Apr — back up Baldry Shield**

**13 Apr — Last day of Term 1, 2018**

### **BALDRY SHIELD P&C MEETING**

Our NEXT P&C meeting for 2018 will be held on **Tuesday 6th March** at WPS in the library, at 2.30pm. Final preparations for The Baldry Shield will be discussed, so we would love as many people as possible at the meeting so that a volunteer roster can be organised.

Thank you in advance



# Assembly Presentation



We presented Joshua and Bradley with their 2016 awards.

Our Year 6 students now have a special shirt to celebrate their senior year at Wallendbeen Public School.



# Cooking in the kitchen during German lessons



Today were extending our German lessons in the kitchen and made delicious keckses which we will sell at the Baldry Shield.

We used butter zucher (sugar) ei (egg), mehl (flour) and vanille (vanilla). A fun way to learn German. Thank you Mrs Clark

# School Attendance



## EVERY MINUTE COUNTS....

When your child misses just...	that equals...	which is...	and therefore, from Kindy to Year 12, that is...
10 minutes a day	50 minutes of learning each week	Nearly 1½ weeks per year	Nearly ½ a year of school
20 minutes a day	1 hour and 40 minutes of learning each week	Nearly 2½ weeks per year	Nearly a year of school
½ hour a day	½ a day of learning a week	4 weeks a year	Nearly 1 ½ years of learning
1 hour each day	1 whole day of learning each week	8 weeks per year or nearly a term a year.	Over 2 ½ years of learning

*Your child's best learning time is at the beginning of the day...*

**Check the time your school starts. DON'T BE LATE!**

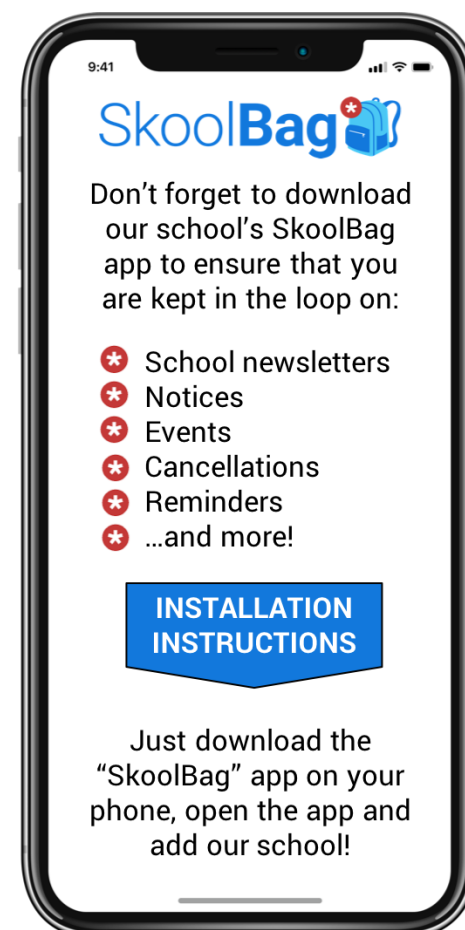

The students say a hug "thanks Rob" for their new fridge!